

Quick Start Guide - SIREC D300 and D400 Display Recorders

1. Connections

D300 rear panel

1) 24VDC Inst. power
2) 24V TXP Supply
3) Common Relay Output
4) RS485 connection
5) USB Host
6) Ethernet connection
7) AC supply 100-250VAC
8) CJC Connector

D400 rear panel

**Analogue Input board (4, 6 or 8 channel).
D300 = Slots A & B, D400 = Slots A to F**

Analogue Output (2 or 4 channel). D300 = Slot B only, D400 = Slots E&F

Pulse Input (4 channel). D300 = Slots A & B, D400 = Slots A to F

Relay Alarm (4 or 8 channel). D300 = Slot G, D400 = Slots G to I

**Digital Input/Output (8 or 16 channel).
D300 = Slot G, D400 = Slots G to I**

Key: NO = Normally Open, C = Common, NC = Normally Closed,
(2) 24V Transmitter Power Supply connections are made via 2-way for D300, 2x10-way connectors for D400.

2. Setup Menu

Select the Menu button from the Process Screen

Configure Setup Edit

Options

Select Options in Credits menu, tick firmware options to enable. Go to Finish and Commit

Inputs

All Analogue Inputs default to 12V

Select Input channel

- Setup input Type. V, A, Ohms, RT, TC
- Select Sample Rate
- Select Range / RT / TC Type

Use Back button to return to Setup Menu

Pens

By default Pen 1 displays Analogue Input 1, Pen 2 displays Analogue 2 etc.

Select Pen

- Setup Scale
- Set Alarms, if required
- Setup Logging (required to Log and Save data in memory)

Use Back button to return to Setup Menu

Localization

Settings for Language and Time Zones, etc.

Back

Settings (Main Menu > Configure)

Set Date and Time

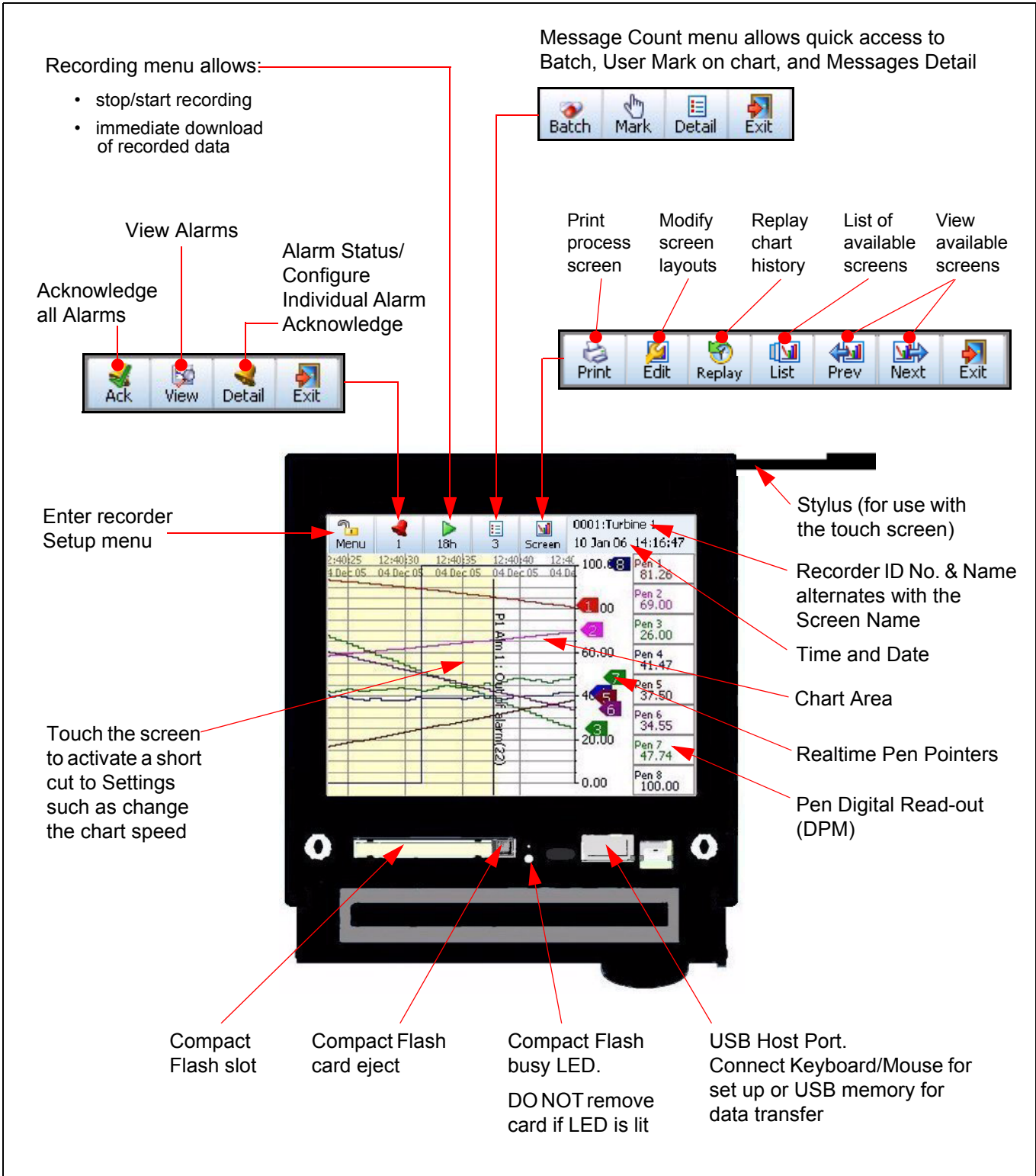

NOTICE

For detailed information on all recorder settings and configuration parameters please refer to the SIREC D200, D300, D400 Manual.