

EXISTING CUSTOMER IDLER

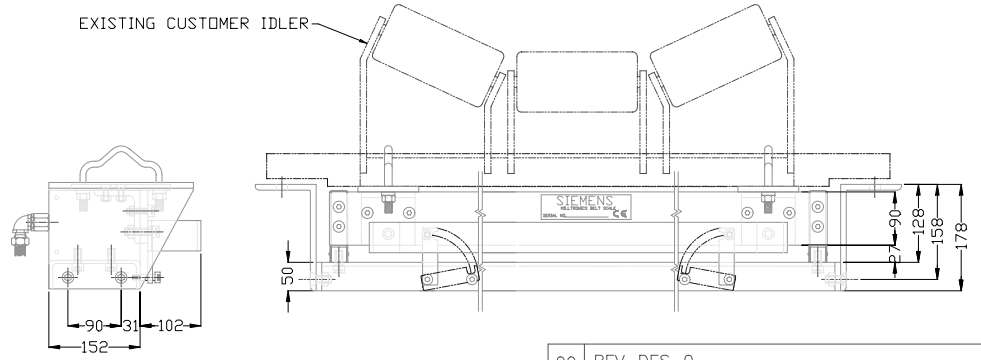

SYSTEM SPECIFICATION	
MSI PART No:	7MH7122-1ANXX-XA
SERIAL No:	XXXXXXXX
LOAD CELL CAPACITY:	XXXXXXXX
CAL WEIGHT PART No:	7MH77241XX QTY. X
ENGINEERED BY:	XXXXXXXX

BELT WIDTH	A	B	STATIC BEAM	SPACER BLOCKS	C	D	E	F
30"	990	896	30"	0	800	698	635	505

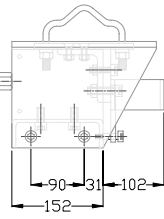

00	REV_DES_0
No	DESCRIPTION

REVISIONS



FILE #	XXXXXXXX	DRAWING NUMBER	XXXXXXXXXXXXXXXXXX	REV	00
JOB No.	--	SHEET 1 OF 1			

CONFIDENTIAL
IMPORTANT NOTICE

THIS DOCUMENT REMAINS THE PROPERTY OF SIEMENS AND IS SUBJECT TO RECALL. IT MAY NOT BE COPIED, AND IS ISSUED AND CAN BE UTILIZED ONLY FOR SUCH LIMITED PURPOSES AS MAY SPECIFICALLY HAVE BEEN AUTHORIZED BY SIEMENS. IT IS TO BE MAINTAINED CONFIDENTIAL, SINCE IT MAY CONTAIN PROPRIETARY INFORMATION AND TRADE SECRETS OF SIEMENS OR OTHERS. THE ITEMS DEPICTED MAY THEMSELVES BE THE SUBJECT OF PATENTS, INDUSTRIAL DESIGN REGISTRATIONS OR COPYRIGHTS OF SIEMENS OR OTHERS, AND THE ISSUE OF THIS DRAWING DOES NOT IMPLY ANY LICENSE UNDER ANY SUCH RIGHTS.

COPYRIGHT SIEMENS
ALL RIGHTS RESERVED

SCALE:	N.T.S.	DATE		ALL DIMENSIONS IN MM UNLESS OTHERWISE NOTED	THIRD ANGLE
DRAWN:	X.X.X.	XX/XX/XX		TOLERANCES UNLESS OTHERWISE NOTED	
CHECKED:	X.X.X.	XX/XX/XX		0-300 = ±0.30	
APPROVED:	X.X.X.	XX/XX/XX		300 + = ±0.75 ANGLE= ±0.5°	
			TITLE	MSI BELT SCALE 30" BELT WIDTH CUSTOMER APPROVAL DRAWING CLIENT = XXXXXXXX	